

SCALE 1: 25,000

LOCALITY PORTLAND

ENVIRONMENTAL PLANNING & ASSESSMENT ACT, 1979

CITY OF GREATER LITHGOW

RURAL RESIDENTIAL DEVELOPMENT CONTROL PLAN
 ZONE - 1(c) L.E.P. 1994



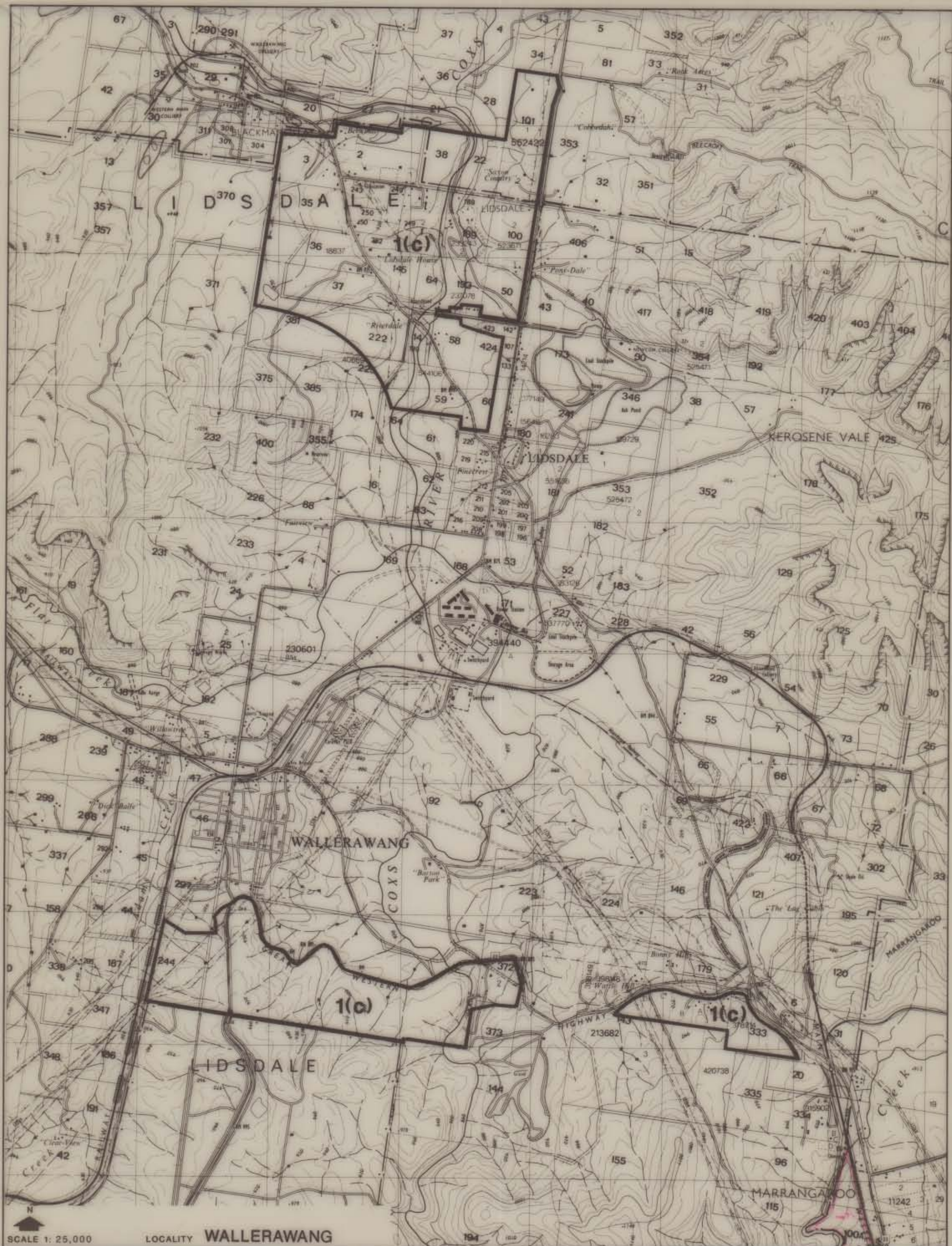

SCALE 1: 25,000

LOCALITY WALLERAWANG

ENVIRONMENTAL PLANNING & ASSESSMENT ACT, 1979

CITY OF GREATER LITHGOW

RURAL RESIDENTIAL DEVELOPMENT CONTROL PLAN
 ZONE - 1(c) L.E.P. 1994

↑
 See LEP 1994
 Rural map

SHEET 2 OF 5 SHEETS



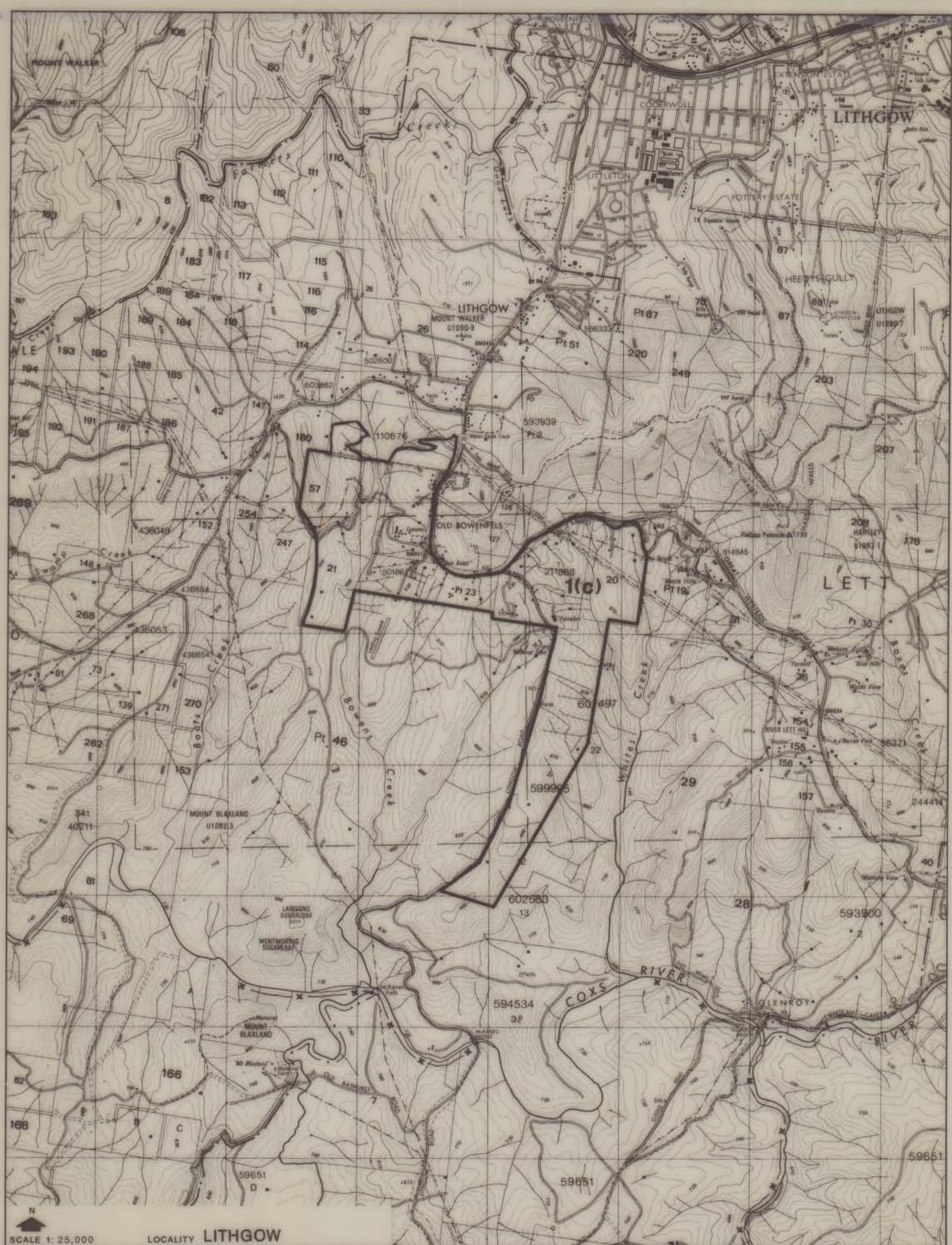

SCALE 1: 25,000

LOCALITY LITHGOW

ENVIRONMENTAL PLANNING & ASSESSMENT ACT, 1979

CITY OF GREATER LITHGOW

RURAL RESIDENTIAL DEVELOPMENT CONTROL PLAN
 ZONE - 1(c) L.E.P. 1994

SHEET 3 OF 5 SHEETS





SCALE 1: 25,000

LOCALITY HARTLEY

ENVIRONMENTAL PLANNING & ASSESSMENT ACT, 1979

CITY OF GREATER LITHGOW

RURAL RESIDENTIAL DEVELOPMENT CONTROL PLAN
 ZONE - 1(c) L.E.P. 1994

SHEET 4 OF 5 SHEETS



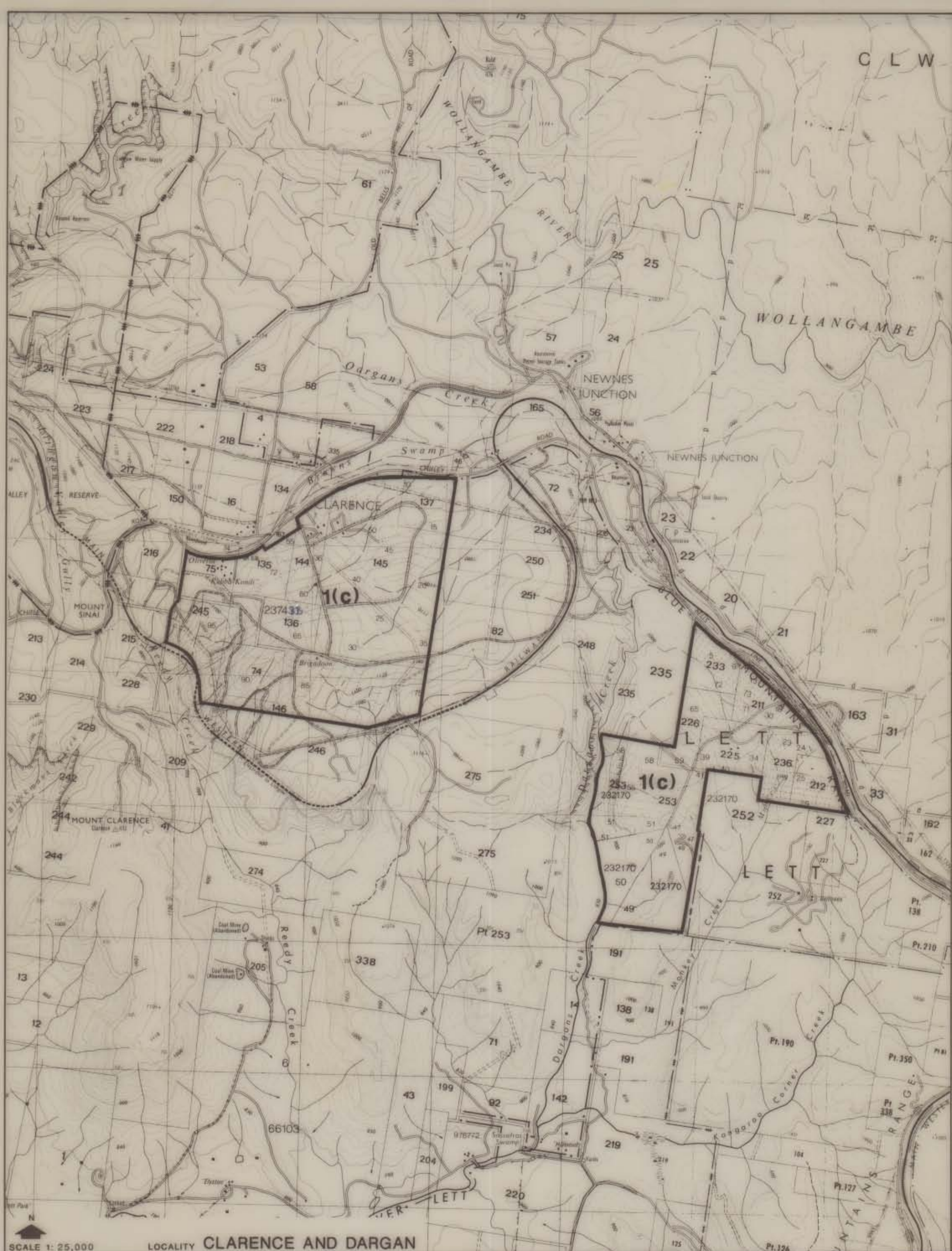

SCALE 1: 25,000

LOCALITY CLARENCE AND DARGAN

ENVIRONMENTAL PLANNING & ASSESSMENT ACT, 1979

CITY OF GREATER LITHGOW

RURAL RESIDENTIAL DEVELOPMENT CONTROL PLAN
ZONE - 1(c) L.E.P. 1994

